

# INSTALLATION INSTRUCTIONS & PARTS DIAGRAM

## PHOENIX DOOR SYSTEMS GATE/CAFÉ HARDWARE

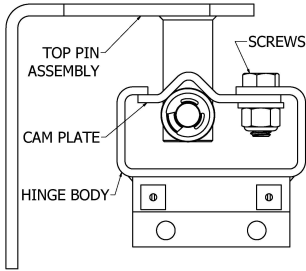

JAMB MUST BE SQUARE AND PLUMB  
A MINIMUM OF 3 1/2" WIDE JAMB  
REQUIRED TO MOUNT HARDWARE

- 1) Measure width and height of opening and compare to dimensions given at time of ordering. This door was fabricated specifically to the dimensions provided by the customer and is not adaptable to fit into a different size opening.
- 2) Position bottom pin assembly at the desired height from floor and centered on jamb. Secure to jamb, using four of the screws provided.
- 3) Remove two bolts in top hinge assembly, to separate top pin assembly and cam plate from the hinge body. Using the top pin assembly as a template, locate it by using the door height plus 1 1/2" as the dimension from the bottom of the bottom hinge bracket to the top of the top pin bracket. Mark the mounting hole locations, making sure that it is in line with, and plumb to the bottom pin assembly. Install the top pin assembly to the jamb, using four of the screws provided.
- 4) Fit door over bottom pin and lift slightly to slide upper hinge body onto the cam plate. Re-insert bolts and nuts which were removed previously, leaving nuts slightly loose. rotate door panel to rest at the desired closed position and tighten nuts.
- 5) Install hinge covers and secure with the four screws provided.

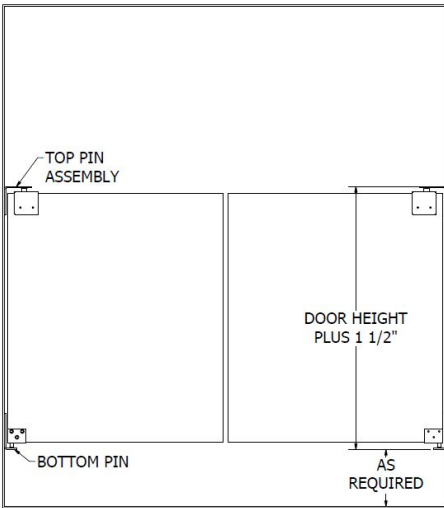

TOP PIN ASSY - P10014

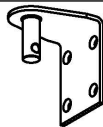

CAM PLATE - P10007



AXLE - P10019



ROLLERS (2) - P10016



RETAINING CLIP (2) - H10001



SS COVERS (2) - P10010, P10011



BOTTOM PIN ASSY - P10004

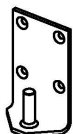

**PHOENIX DOOR SYSTEMS**  
 7390 Union Centre Blvd.  
 West Chester, OH 45014

888-263-4082

[www.PhoenixDoorSystems.com](http://www.PhoenixDoorSystems.com)



**PHOENIX**  
**DOOR SYSTEMS**