



PHOENIX DOOR SYSTEMS

7390 Union Centre Blvd.
West Chester, OH 45014
PHONE TOLL FREE
1-888-263-4082

PHOENIX SERIES INSTALLATION INSTRUCTIONS

page 1

PREPARATION

CHECK ALL CONTENTS OF THE PACKAGE TO BE SURE ALL PARTS WERE INCLUDED IN SHIPPED PACKAGE. FOR MISSING OR DAMAGED PARTS CONTACT THE FACTORY IMMEDIATELY.

MEASURE THE FINISHED OPENING AND COMPARE WITH ORDER MEASUREMENTS ON SHIPPING CRATE.

INSPECT DOOR JAMB TO VERIFY THAT IT IS PLUMB, SQUARE AND SECURE.

DOOR JAMBS MUST BE A MINIMUM 3" DEEP X 3 1/2" WIDE, WITH NO GAPS, BEFORE BEGINNING INSTALLATION (SEE FIGURE 2-A)

NOTE: DOORS MUST BE INSTALLED PLUMB IN ORDER TO OPERATE PROPERLY.

IF FRAME OPENING DOES NOT MATCH ORDER DIMENSIONS CALL THE FACTORY TOLL FREE @ 1-888-263-4082

DRILL SIZES

FOR (3) (4)
FOR 5/16" X 3" LAG SCREWS
USE 1/4" DRILL BIT
FOR 5/16" -18 HEXHEAD THREAD CUTTING
USE 9/32" DRILL BIT

FOR CONCRETE FLOOR
USE 3/8" CONCRETE ANCHOR

FASTENERS

FOR (4) QTY. 4
FOR STEEL JAMB
USE: 5/16" - 18 HEXHEAD THREAD CUTTING
FOR WOOD JAMB
USE: 5/16" X 3" LAG SCREW
FOR (3) (JAMB) QTY. 4
FOR STEEL JAMB
USE: 5/16" - 18 HEXHEAD THREAD CUTTING
FOR WOOD JAMB
USE: 5/16" X 3" LAG SCREW
FOR (3) (FLOOR) QTY. 2
FOR CONCRETE FLOOR
USE: 3/8" CONCRETE ANCHOR

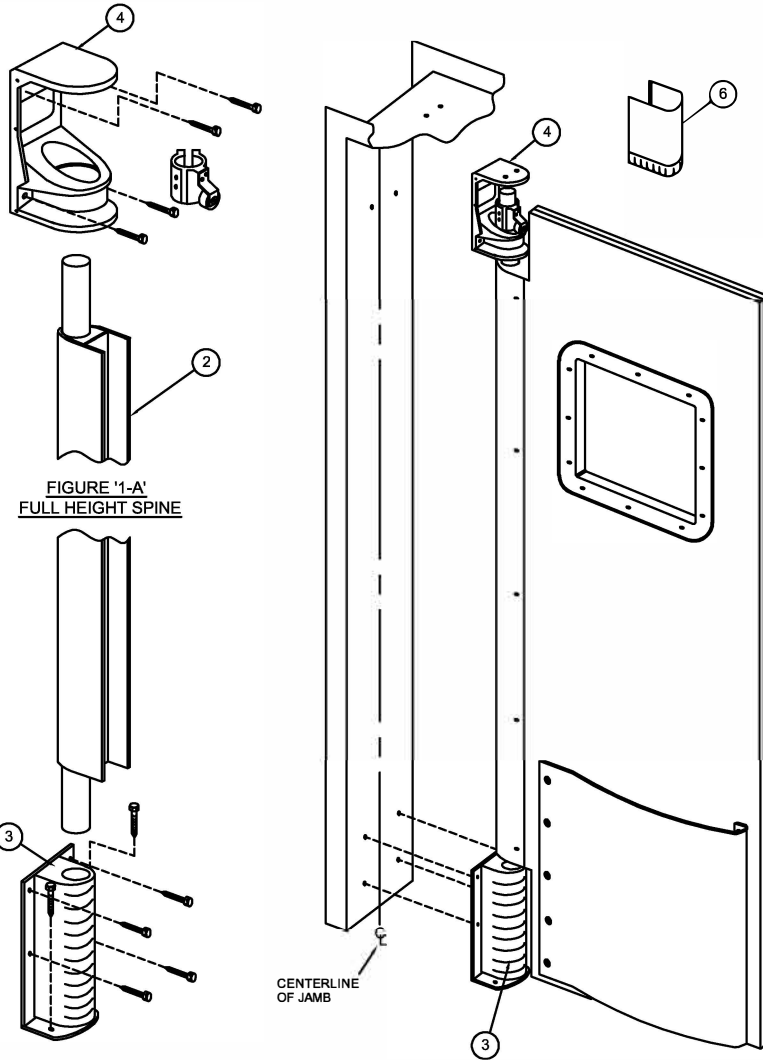

FIGURE '1-A'
FULL HEIGHT SPINE

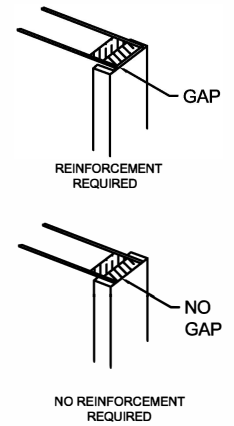

FIGURE '2-A'

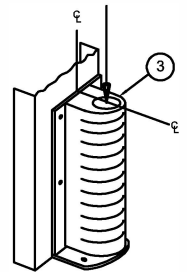

FIGURE '2-B'

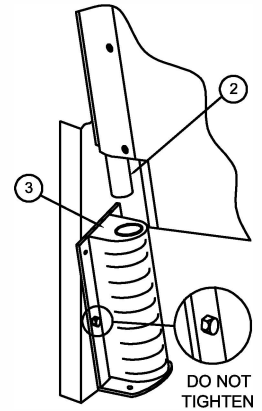

FIGURE '2-C'

THE USE OF SAFETY GLASSES FOR EYE PROTECTION IS RECOMMENDED WHEN POWER TOOLS ARE USED

STEP #1 MARKING AND DRILLING JAMB

NOTE: PROCEED ONLY AFTER COMPLETING PREPARATION SECTION ABOVE.

ESTABLISH THE CENTERLINE OF JAMB AND HEADER. PLACE CAM (4) ON THE INSIDE OF JAMB WITH THE TOP CORNER TOUCHING THE HEADER AND JAMB. LINE UP CENTER OF CAM (4) WITH CENTERLINE OF JAMB AND HEADER. MARK THE SIX HOLES IN THE CAM (4) ONTO THE JAMB AND HEADER. REMOVE CAM (4)

PLACE JAMB GUARD (3) IN THE LOWER CORNER OF THE JAMB.

DROP A PLUMB BOB FROM THE CENTERLINE OF HEADER AND JAMB TO THE JAMB GUARD (3) (SEE FIGURE 2-B)

AFTER ALIGNING THE CENTERS OF THE CAM AND JAMB GUARD, MARK THE HOLES IN THE JAMB GUARD AND DRILL PER THE SIZES LISTED ABOVE.

STEP #2 ATTACHING HARDWARE

ATTACH JAMB GUARD (3) TO THE JAMB (WITH BASE ON THE FLOOR) USING A SINGLE FASTENER. LEAVE FASTENER APPROXIMATELY 1/4" FROM BEING TIGHT, TIGHTEN LATER SEE (SEE FIGURE 2-C)

TILT THE JAMB GUARD (3) APPROXIMATELY 30° ANGLE AS SHOWN IN FIGURE 2-C THIS WILL ALLOW YOU INSERT SPINE SHAFT (2) INTO THE JAMB GUARD (3) WITHOUT INTERFERENCE FROM THE HEADER (SEE FIGURE 2-C). LIFT THE DOOR AND SLIDE THE SPINE SHAFT (2) INTO THE JAMB GUARD (3) (SEE FIGURE 2-C)

PLACE CAM (4) OVER SPINE SHAFT (2), THEN PLACE BEARING CLAMP (5) OVER THE SPINE SHAFT (2), DO NOT TIGHTEN (SEE FIGURE 1-A).

STAND DOOR UPRIGHT IN JAMB. LINE UP THE CENTER OF CAM (4) WITH THE CENTER OF JAMB, HEADER AND JAMB GUARD (3).

INSERT THE REMAINING FASTENERS INTO THE CAM (4) AND JAMB GUARD (3) TIGHTEN ALL HARDWARE.

STEP #3 HANGING DOOR

PLACE THE SUPPLIED WOOD BLOCK (7) UNDER THE DOOR AND ON TOP OF THE JAMB GUARD (3) AS A TEMPORARY SHIM. (SEE FIGURE 3-A PAGE #2)

NOTE: TOP OF THE BEARING CLAMP (5) SHOULD NOT BE ABOVE THE TOP OF THE SPINE SHAFT (2) IF IT IS DOOR MUST BE ADJUSTED UP WITH ADDITIONAL SHIMS BEFORE TIGHTENING. SEAT THE BEARING CLAMP (4) ON THE SPINE SHAFT (2) WITH THE BEARING AT THE LOWEST POINT ON THE V-CAM. (SEE FIGURE 3-B [PAGE 2]).

IMPORTANT: LINE UP THE CENTERLINE OF THE DOOR WITH THE CENTERLINE OF THE JAMB HEADER (SEE FIGURE 4-A [PAGE 2]).

PHOENIX DOOR SYSTEMS - 7390 Union Centre Blvd. - West Chester, OH 45014

PH: 513-492-8213 TOLL FREE 888-263-4082 WWW.PHOENIXDOORSYSTEMS.COM



PHOENIX DOOR SYSTEMS

7390 Union Center Blvd.
West Chester, OH 45014

PHOENIX SERIES INSTALLATION INSTRUCTIONS

page 2

STEP #4 ADJUSTING THE SWING

AFTER ALIGNMENT OF CENTERLINE OF DOOR WITH CENTERLINE OF JAMB AND HEADER, ALTERNATE TIGHTENING FROM ONE CAP SCREW TO THE OTHER. TIGHTEN THE TWO SOCKET HEAD CAP SCREWS IN THE BEARING CLAMP (5) AS TIGHT AS POSSIBLE USING THE 3/16" ALLEN WRENCH (SUPPLIED) (SEE FIGURE 5-A).

IMPORTANT: MAKE ALL ADJUSTMENTS AND TEST DOOR FOR PROPER SWING BEFORE CONTINUING AFTER MAKING ALL ADJUSTMENTS AND TESTING FOR PROPER SWING, TIGHTEN THE SET SCREWS LOCATED AT EACH SIDE OF THE BEARING CLAMP (SEE FIGURE 5-A)

LOCATE THE 1/4" HOLE JUST ABOVE ONE OF THE SET SCREWS ON THE BEARING CLAMP (5) USING A 7/32" DRILL BIT. DRILL A 3/4" DEEP HOLE INTO THE HINGE SHAFT THROUGH THE 1/4" HOLE.

USING A 3/8" BOX END OR SOCKET AND RACHET, ATTACH AND TIGHTEN THE SHAFT SECURING BOLT (SEE FIGURE 5-A). THE DOOR IS NOW PERMANENTLY SET IN THE ADJUSTED POSITION.

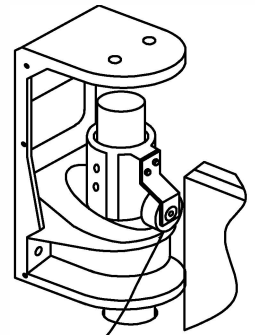

LOWEST POINT ON V-CAM

FIGURE '3-B'

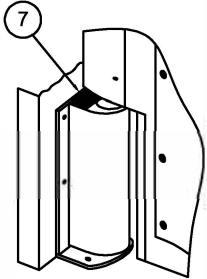

FIGURE '3-A'

STEP #5 FINISHING

BEFORE INSTALLING THE HINGE COVER (6) LUBRICATE HINGE SHAFTS AT TOP AND BOTTOM WITH SILICONE SPRAY OR SIMILAR LIGHT WEIGHT OIL (SEE CARE AND MAINTENANCE SECTION BELOW) ATTACH HINGE COVER (6) USING THE 1/2" STAINLESS MACHINE SCREWS (SUPPLIED) (SEE FIGURE 6-A)

INSTALL THE HEADER GASKET ALONG THE CENTERLINE OF THE DOOR JAMB HEADER USING THE 1" SHEET METAL SCREWS (SUPPLIED) (SEE FIGURE 6-B) CUT THE FLEXIBLE PORTION OF THE TOP SEAL BETWEEN THE TWO PANELS OF BI-PARTING PAIRS.

REMOVE THE PROTECTIVE COATINGS FROM THE WINDOWS AND OTHER SURFACES. CLEAN THE ENTIRE DOOR AND JAMB FOR A NEW APPEARANCE.

IF THE GAP BETWEEN THE TOP OS THE DOOR AND THE HEADER IS LESS THAN 2", TRIMMING OF THE HEADER GASKET WILL BE NECESSARY. THE GASKET SHOULD TOUCH THE TOP OF THE DOOR PANEL.

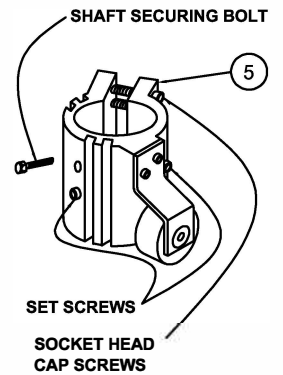

SHAFT SECURING BOLT
SET SCREWS
SOCKET HEAD CAP SCREWS

FIGURE '5-A'

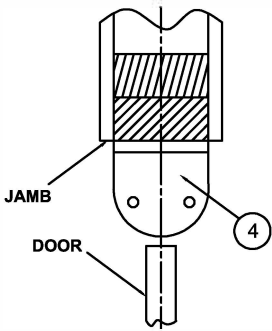

FIGURE '4-A'

CARE AND MAINTENANCE

DOORS CAN BE WASHED WITH A MILD DETERGENT AND WATER. **DO NOT USE ACETONES, CHLORINATED SOLVENTS, OR OTHER CHEMICALS** OF THIS TYPE.

LUBRICATE SPINE SHAFT AND CAM ROLLER AREA EVERY 90 DAYS WITH SILICONE SPRAY, OR SIMILAR LIGHTWEIGHT OIL.

TROUBLE SHOOTING GUIDE

PROBLEM	CHECK POINT NUMBERS
DOOR WILL NOT CLOSE AT ALL	1,2,3,8
DOOR IS NOT RETURNING TO CENTER	2,3,4,5,8
DOOR WILL NOT OPEN COMPLETELY	6,7
DOOR CLOSES EXTREMELY SLOW	1,8

CHECK POINT NUMBERS	POSSIBLE CAUSES	SOLUTIONS	REFER TO I NSTRUCTIONS
1)	HINGES NOT INSTALLED PLUMB		STEP 2
2)	BEARING CLAMP NOT TIGHTENED CORRECTLY		STEP 3
3)	BEARING CLAMP NOT SEATED ON LOWEST POINT OF BEARING RACE		STEP 3
4)	DOOR INSTALLED TOO LOW AND STOPS ON FLOOR		STEP 3
5)	BEARING CLAMP AND DOOR NOT ALIGNED WITH CENTER OF JAMB		STEP 3
6)	DOOR INSTALLED TOO HIGH AND TOP EDGE HITS THE JAMB HEADER.		STEP 3
7)	DOOR INSTALLED TOO LOW AND TOP OF HINGE SHAFT HITS INSIDE TOP OF CASTING.		STEP 2
8)	AIR FLOW AFFECTS CLOSING. SPRING ASSIST OPTION MAY BE NEEDED.		

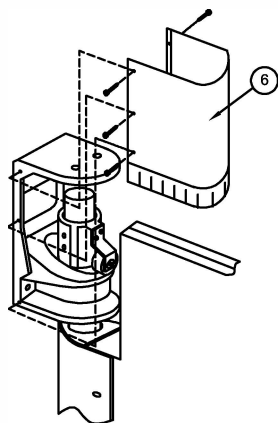
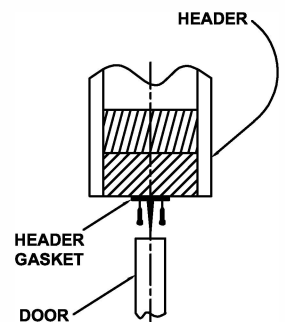

FIGURE '6-A'



HEADER
HEADER GASKET
DOOR

FIGURE '6-B'