

2

1

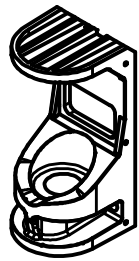
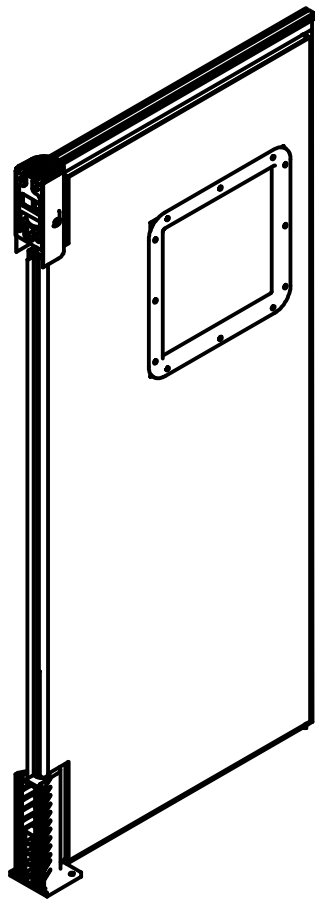

Upper V-Cam
 "Composite"
 Part # P100458
 QTY: _____
 #P100668- Cast
 Upper V-Cam

Upper V-Cam
 "Aluminum"
 Part # P100106
 QTY: _____

Upper V-Cam
 "Zinc-Plated Cast
 Iron"
 Part # P100668
 QTY: _____

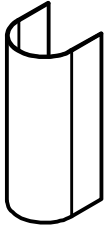

V-Cam Cover
 "Reinforced
 Flexible PVC"
 Part#P100107
 QTY: _____

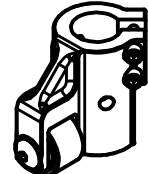

**Bearing Clamp
 Assembly**
 "Steel"
 Part#P100157
 QTY: _____
 "Stainless Steel"
 Part#P100203
 QTY: _____

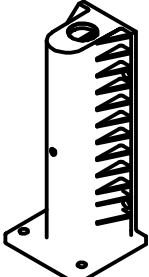

**4"x12" Jamb
 Guard**
 "Composite"
 Part#P100457
 QTY: _____

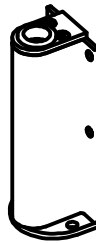

**3"x9" Jamb
 Guard**
 "Aluminum"
 Part#P100206
 QTY: _____

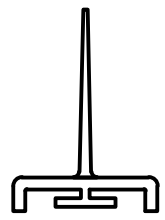

2" TOP SEAL
 "Co-extrusion PVC"
 Length : 70.87"
 Part# M300028
 QTY: _____

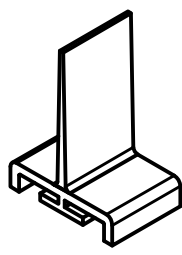

2" TOP SEAL
 "Co-extrusion PVC"
 Length : 94.49"
 Part# M300029
 QTY: _____

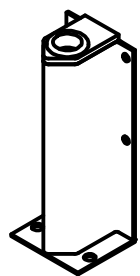

**4"x12" Jamb
 Guard**
 "Stainless Steel"
 Part#P300042
 QTY: _____



Channel Gasket
 "Rubber"
 Part #P100218
 QTY (FT): _____

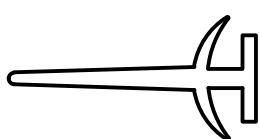

1" Blade Gasket
 "Rubber"
 Leading/Bottom
 Edge
 Part# P100200
 QTY (FT): _____

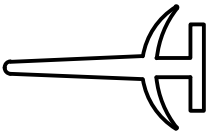

3/4" Blade Gasket
 "Rubber"
 Hinge Edge
 Part# P100260
 QTY (FT): _____

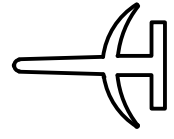

1/2" Blade Gasket
 "Rubber"
 Optional
 Part# P100259
 QTY (FT): _____

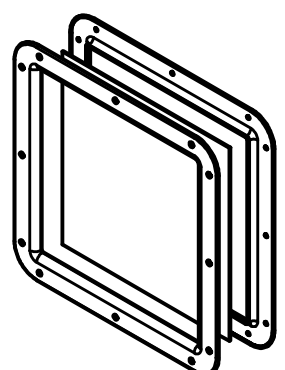

**See Window
 Replacement Sheet**



**PHOENIX
 DOOR SYSTEMS**

DRAWN	EAR	
CHECKED		
QA		
MFG		
APPROVED		
DWG NO		

PHOENIX DOOR SYSTEMS
 TITLE
**Phoenix Model
 Replacement Parts**

REV

2

4

1

B

B

A

A